

# NanoDrop Lite Printer Quick Reference Guide

## Using NanoDrop Lite With Optional Printer

### ❖ To connect NanoDrop Lite to printer

1. Ensure power supply is disconnected from both the NanoDrop™ Lite and the printer.
2. Firmly push the instrument onto the printer base as shown.  
The instrument will snap into place when properly docked. The NanoDrop Lite is now powered through the printer.

**Figure 1.** Connecting the NanoDrop Lite to the printer



### ❖ To load paper into printer

1. Make sure the instrument is fully docked onto the printer.  
The printer assembly will not work until the NanoDrop Lite is properly docked.
2. Plug in the power supply to printer and allow NanoDrop Lite to initialize.

**Figure 2.** Back view

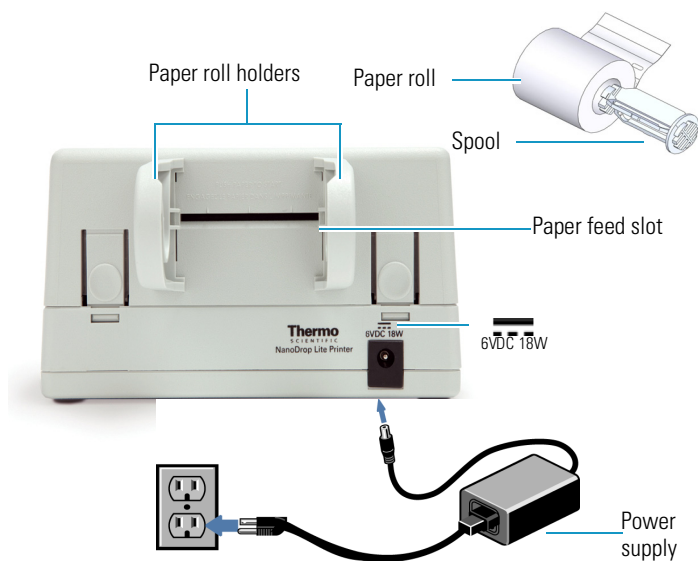

3. Unwrap paper roll, insert spool and set the paper roll squarely behind the printer, in the orientation shown on the icon located on the side of the paper holders.

The paper should be coming out from under the roll toward the feed slot.

**Figure 3.** Paper holder

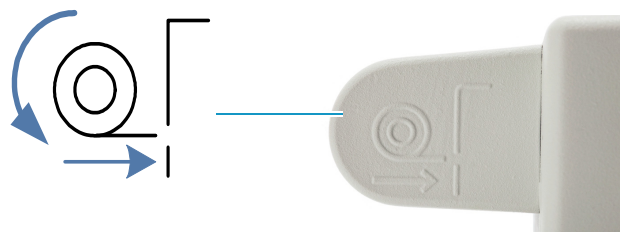

4. When you hear the paper feed mechanism move and the Home screen appears on the NanoDrop Lite, the printer is ready to load the paper; push the end of the paper into the paper feed slot on the printer back cover.

Paper is properly inserted when it engages the print head mechanism and comes out from the slot at the top of the printer.

**Figure 4.** Inserting paper

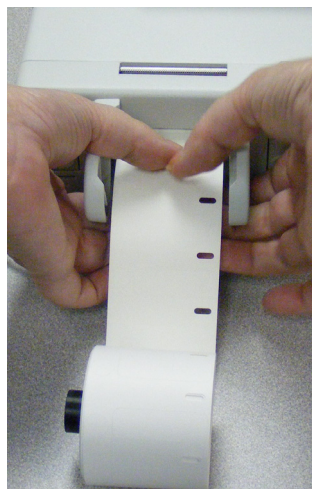

5. Insert the paper roll (with the spool) into the paper roll holder.
6. Press Feed from the Home screen to advance the paper.

**Figure 5.** The Feed option appears on the Home screen when NanoDrop Lite is docked on the printer

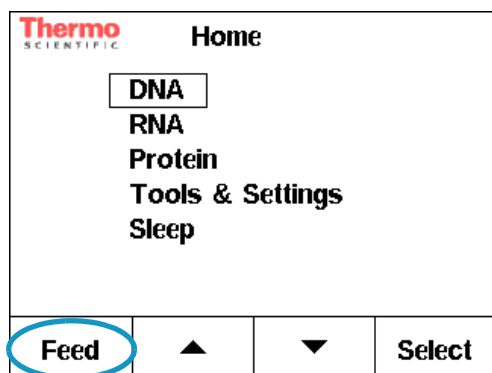

**Tip** Helpful tips for installing the paper

- Keep the paper centered as it enters the slot on the back of the printer.
- Grab the paper as close to the paper feed slot as possible when feeding into the printer.
- You will hear a noise as the paper engages in the printer. At this time, firmly push the paper into the slot to get it started.
- If none of the above works, clip a small corner from the ends of the paper and reinsert the paper.

### Troubleshooting Paper Feed

If the paper does not feed properly (no paper comes out from the top of the printer), remove the paper from the printer and repeat steps 2 through 6.

❖ **To remove paper from printer**

1. Unplug the power supply to printer.
2. Remove panel from back of printer by pushing the two release buttons on either side of the paper holders while simultaneously pulling the panel up.

**Figure 6.** Release button location

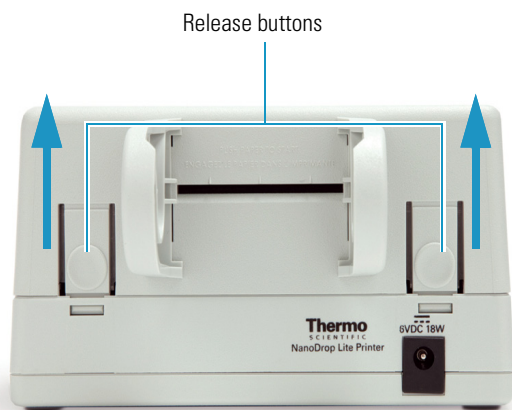

Once the panel has been removed, you will see a green rocker switch on the right side of the roller.

3. Press switch down to release paper (see [Figure 7](#)).
4. Pull paper gently out of the printer.

**Figure 7.** Rocker switch location

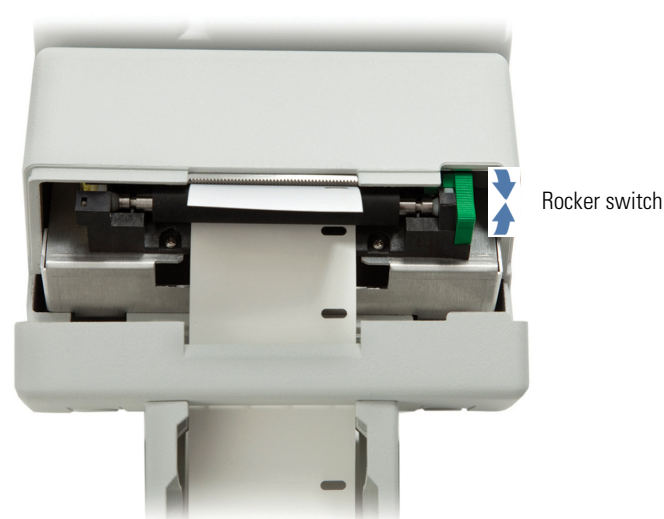

5. Push the green switch up to the horizontal position once paper has been removed.

**Tip** Ensure you return switch to horizontal position before you put the panel on.

6. Snap back panel into place.
7. Plug in the power supply to printer, allow instrument to initialize and repeat the steps in “To load paper into printer” section.

### Printing Labels

When the instrument is connected to the printer, there are three ways to print sample labels:

- If **Autoprint** is **ON**, a label will print automatically after each sample measurement.
- To change Autoprint navigate to **Home > Tools & Settings > Settings**. Press **Change** to toggle to **Autoprint On** or **Autoprint Off**.
- When Autoprint is turned off, press **Print** after measuring your sample.

If you need to print more than one label for the same sample measurement, press **Print** again.

- Press **Print** when viewing results from previously measured samples in the **Sample History** screen (**Home > Tools & Settings > Sample History**).

This allows you to print labels from previously measured samples that are stored in the instrument’s memory. Use the arrow keys to display the sample data you want to print.

**Note** The printer labels are cryogenic, and per manufacturing specifications they perform well under a wide temperature range: 70° C to -196° C.

## Printer Output

The printed labels provide space above the data for writing the sample name.

**Figure 8.** Printer label

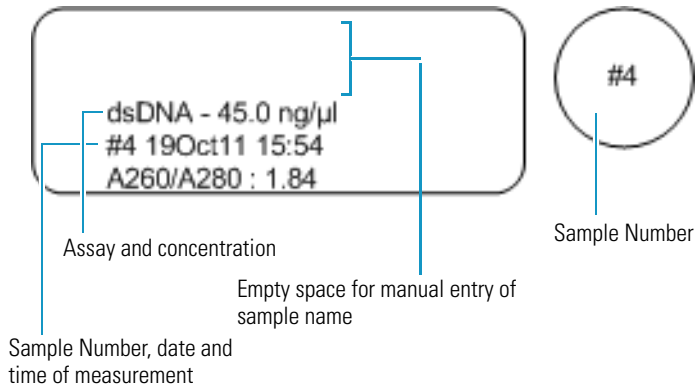

Labels can be used on a 1.5 ml tube or in a lab notebook.

The round sticker next to the label fits the top of a 1.5 ml tube and is provided to use as needed for sample identification.

## Printer Serial Number Location

The printer serial number is located on the label on the bottom of your printer. You will need this number to identify your printer to Technical Support and service.

**Figure 9.** Serial number



---

#### **Trademark Information**

Microsoft Excel is a trademark or registered trademark of Microsoft Corporation in the United States and/or other countries. All trademarks are the property of Thermo Fisher Scientific Inc. and its subsidiaries.

#### **Contact Information**

Thermo Fisher Scientific  
3411 Silverside Road  
Bancroft Building, Suite 100  
Wilmington, DE 19810 U.S.A.  
Telephone: (302) 479-7707  
Toll free: (877) 724-7690 (US & Canada)  
Fax: (302) 792-7155  
E-mail: [nanodrop@thermofisher.com](mailto:nanodrop@thermofisher.com)  
[www.thermofisher.com/nanodrop](http://www.thermofisher.com/nanodrop)